

- Ligature resistant construction for use in behavioral health environments
- 6" Aperture Recessed profile for use in hard ceilings, and grid ceilings
- 6 standard CCT color temperatures
- Wet location, IK10, IP66 when sealed from room side
- Pairs with SensorSwitch™ IWS for local or zonal control with other luminaires

TYPICAL APPLICATIONS

Behavioral health resident room, lavatory, nursing area, activity area

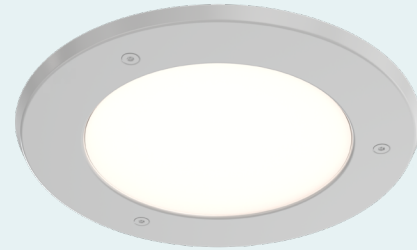

Dimensions

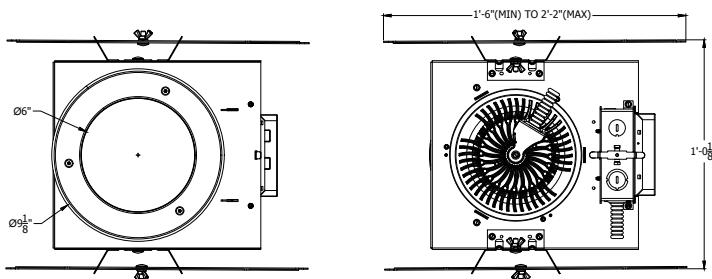

Performance Data

Lumen values are from photometric tests from an accredited laboratory. Data is considered to be representative of the configurations shown, within generally accepted industry tolerances. Performance data based upon 3500K

BASED ON 80CRI 3500K MD CPL

NBDO6 STWH							
NOMINAL LUMENS	1000	1500	2000	2500	3000	3500	4000
DELIVERED	1124	1741	2256	2650	3206	3646	3978
WATTAGE	12.0	18.8	25.4	30.9	39.5	47.4	55.3
EFFICACY	93.9	92.5	88.8	85.7	81.3	77.0	72.0

Catalog Number

Example: NBDO6 MD 3000LM CPL F MVOLT 40K 90CRI ZT DARK GWAM TXPS

Series*		Distribution*		Direct Lumen Output*		Lens*		Mounting*		Voltage*		LED Color Temperature*	
NBDO6	6IN Behavioral Health Downlight	ND	Narrow	1000LM	1,000 Lumens	CPL	Clear Polycarbonate	F ²	Flanged or Grid	120	120V	18K ⁷	1800K
		MD	Medium	1500LM	1,500 Lumens					277	277V	27K	2700K
		WD	Wide	2000LM	2,000 Lumens			GB	Flangeless Mud-In	347 ^{4,5,6}	347V	30K	3000K
				2500LM	2,500 Lumens					MVOLT	120-277V	35K	3500K
				3000LM ¹	3,000 Lumens					40K	4000K		
				3500LM	3,500 Lumens					50K	5000K		
4000LM ¹	4,000 Lumens												
LED Color Rendering		Control Input*		Minimum Dimming Level*		Filters		Fusing		Emergency			
80CRI	80CRI	ZT	0-10V control	DARK ¹	Constant Current, Dimming to <1%	RFI ^{1,6}	Radio Frequency Interference	GLR ¹	Fast Blown Fuse	EMB310T20 ^{1,6,10,11} Self contained, 90 minute emergency battery pack. 0°C (32°F) to 55°C (131°F). Meets CA Title 20 standards GTD ^{1,6,11} Generator Transfer Device			
90CRI	90CRI	DALI	DALI										
		NLIGHT ^{6,8,9,10}	nLIGHT enabled										
		NLTAIR2 ^{6,9,10}	nLIGHT Air (Wireless) Enabled										
Certification		Finish*		Mounting Hardware		Visible Hardware							
CP ¹⁰	Chicago Plenum	GWAM	Gloss White Antimicrobial	<BLANK>	For Ceilings up to 11/4" thick Ceiling Thickness Adapter	TXPS	Painted TORX® tamper resistant screws to match luminaire finish						
		GBKAM	Gloss Black Antimicrobial										
		RALTBD	RAL Color TBD										
		*RALTBD for pricing only. Replace with applicable RAL call out when ready to order. See the Architectural RAL Color Brochure for available options.		CTA									

* Required Fields

Notes

- Not available with 347
- Requires TXPS Visible Hardware
- Only available with AMF
- Only available with ZT
- Not available with DARK
- Not available with CP
- Not available with 80CRI
- Not available with MVOLT
- Not available with EMB310T20
- Not available with GTD
- Not available with RFI and GLR

Specifications

Housing

Luminaire housing constructed of 16-gauge galvanized steel with telescopic mounting bars with maximum 26" and minimum 15" extension and 4" vertical adjustment.

Lens

Impact resistant polycarbonate lens with 0.25" nominal thickness. Available with patented pending flanged or flangeless (GB) trim. If IP66 rating is required, no-pick caulk (or vandal resistant equivalent caulk) is recommended. See Installation Instructions for more detail. Lens and trim secured with tamper resistant center pin reject TORX fasteners to prevent intrusion and mitigate ligature.

Finish

Painted in durable polyester powder coat paint with antimicrobial* additive. Available in two standard solid matte colors. Brushed aluminum with clear coat finish also available.

*Antimicrobial properties are built in to inhibit the growth of bacteria that may affect this product. The antimicrobial properties do not protect users or others against bacteria, viruses, germs, or other pathogens.

Mounting

Luminaire suitable for installations in ceilings up to 1.25 inches thick (specify ceiling thickness adaptor kit for ceilings up to 2.25 thick).

Source

Static white in 1800K, 2700K, 3000K, 3500K, 4000K, or 5000K in either 80CRI or 90CRI standard. All LED within a 2.5 step MacAdam ellipse.

LED Life

Greater than 80% LED lumen maintenance at 60,000 hours (L80>60,000).

Fixture Weight

Weight may vary depending upon options or accessories selected.

Environment

Wet Location standard, IK10, IP66.

Certification

CSA certified to meet U.S. and Canadian standards (UL1598 and UL8750) and CAN/CSA C22.2 No. 250.0. Non-IC rated

Certified for NSF Splash Zone 2 with all finishes except RALTB.D.

Controls

Optional integrated nLight® controls make each fixture addressable - allowing it to digitally communicate with other nLight enabled controls such as dimmers, switches, occupancy sensors, and photocontrols. Connection to nLight is simple. It can be accomplished with remote nLight AIR wireless or through standard Cat-5 cabling (cabling "by others"). nLight offers unique plug-and-play convenience as devices and luminaires automatically discover each other, while nLight AIR is commissioned easily through an intuitive mobile app.

Government Procurement

BAA – Buy American Act: This product is available in a version that qualifies as a domestic end product under the Buy American Act as implemented in the FAR and DFARS. BABA – Build America Buy America: This product is available in a version that qualifies as produced in the United States under the definitions of the Build America, Buy America Act, as implemented by 2 C.F.R. Part 184 and other agency implementing regulations, including Department of Transportation regulations. Please refer to www.acuitybrands.com/resources/buy-american for additional information.

Warranty

5-year limited warranty. This is the only warranty provided and no other statements in this specification sheet create any warranty of any kind. All other express and implied warranties are disclaimed. Complete warranty terms are located at: www.acuitybrands.com/support/warranty/terms-and-conditions

Notes:

Actual performance may differ as a result of end-user environment and application. All values are design or typical values, measured under laboratory conditions at 25 °C. Specifications subject to change without notice.

Distribution

DISTRIBUTION NBDO6 ND

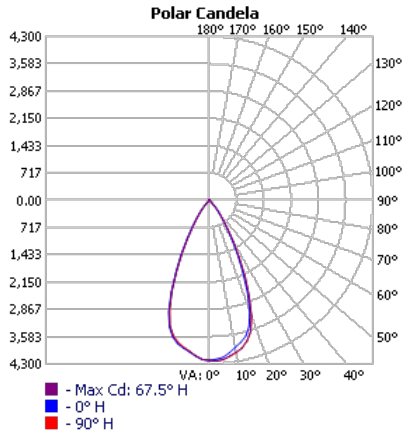

DISTRIBUTION NBDO6 MD

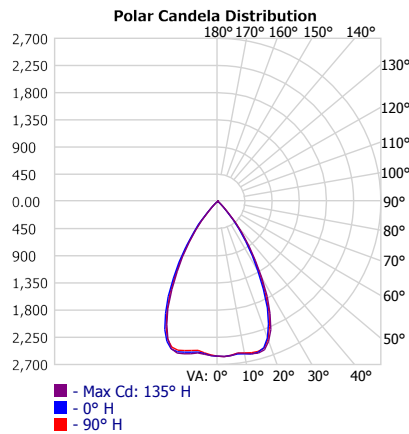

DISTRIBUTION NBDO6 WD

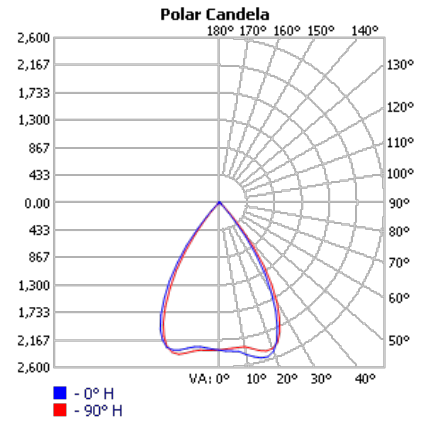

LUMEN MULTIPLIER TABLE FOR CCT & CRI

This table can be used to approximate the lumen values at different kelvin temperatures. Data table baseline is 3500K 80CRI photometry.

CRI	CCT	Scale Factor
80CRI	27K	0.96
	30K	1.00
	35K	1.00
	40K	1.01
	50K	1.07
90CRI	18K	0.38
	27K	0.80
	30K	0.83
	35K	0.85
	40K	0.87
	50K	0.91

Distribution and Lens Multiplier	
MD	1.00
ND	1.03
WD	1.04
CPL	1.000
CAL	1.04

Dimensions

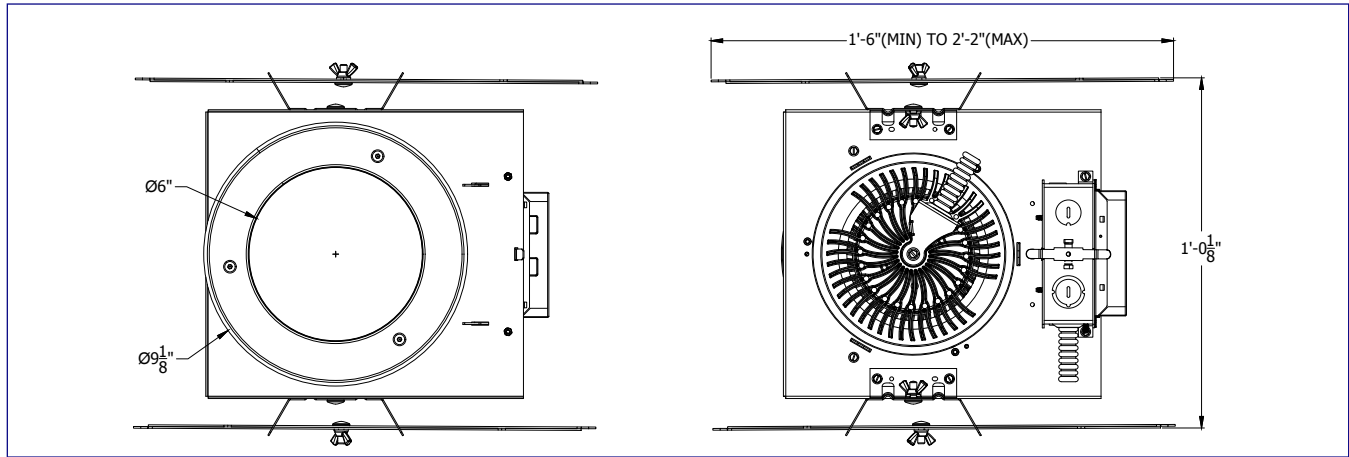

Chicago Plenum

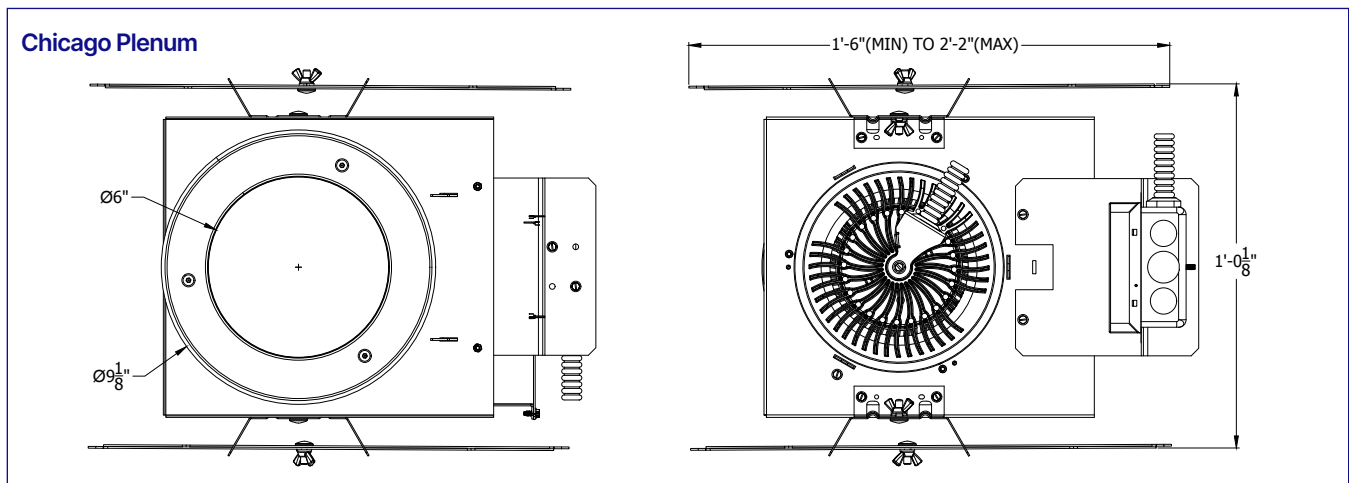

With Emergency Battery/GTD

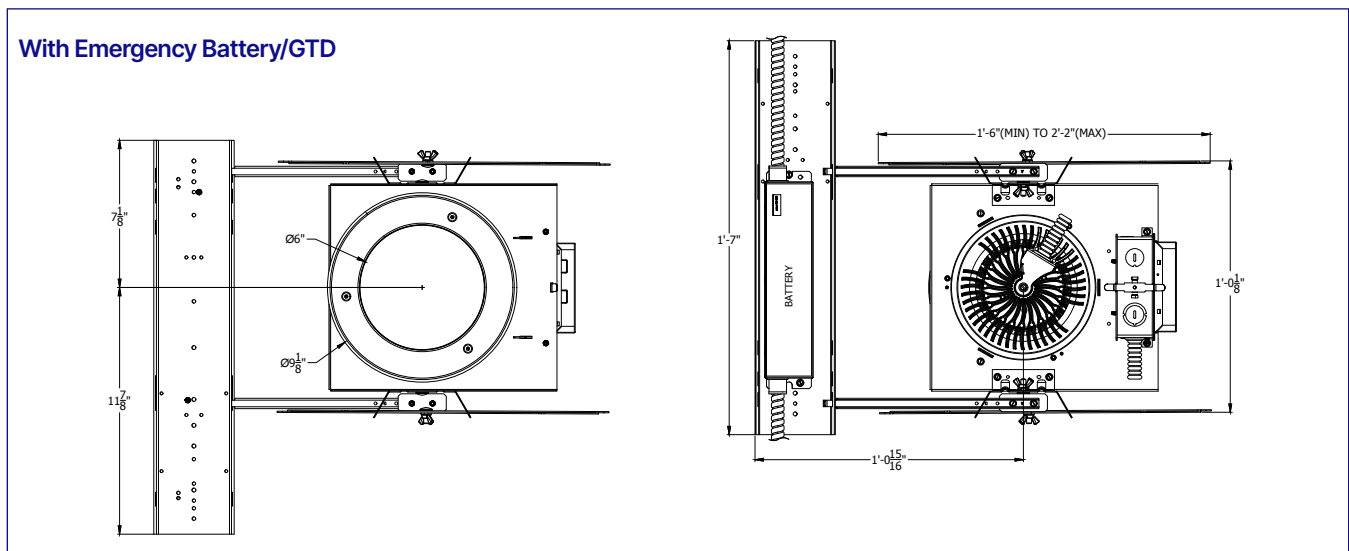

Cross Section Details

F Option

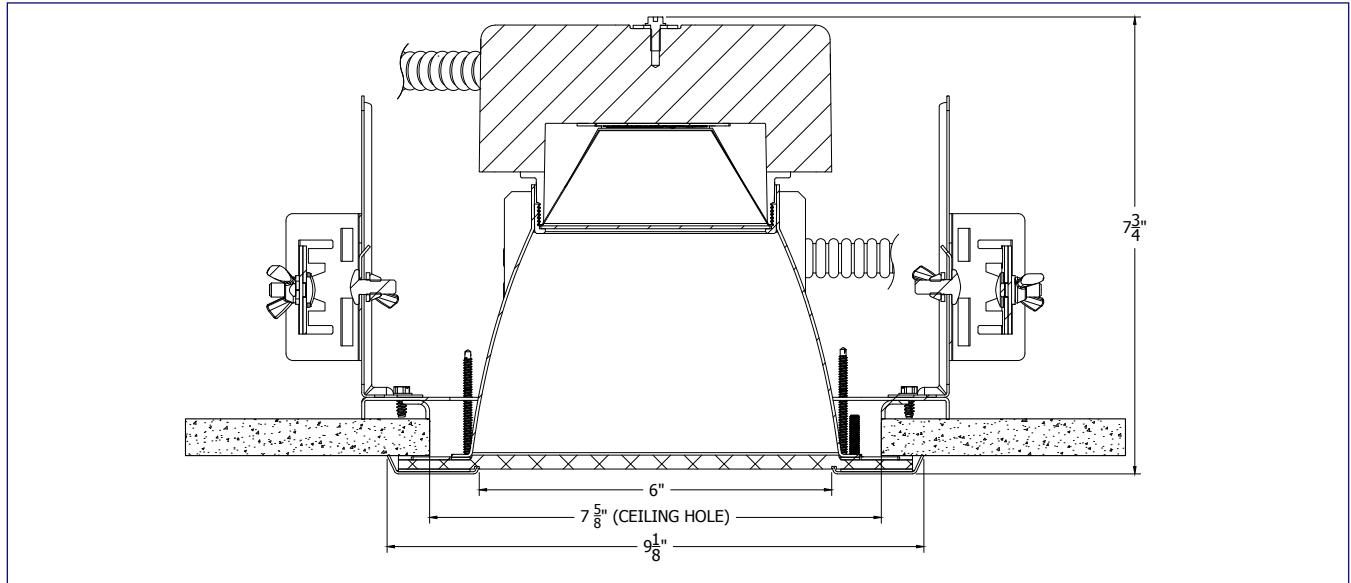

G Option

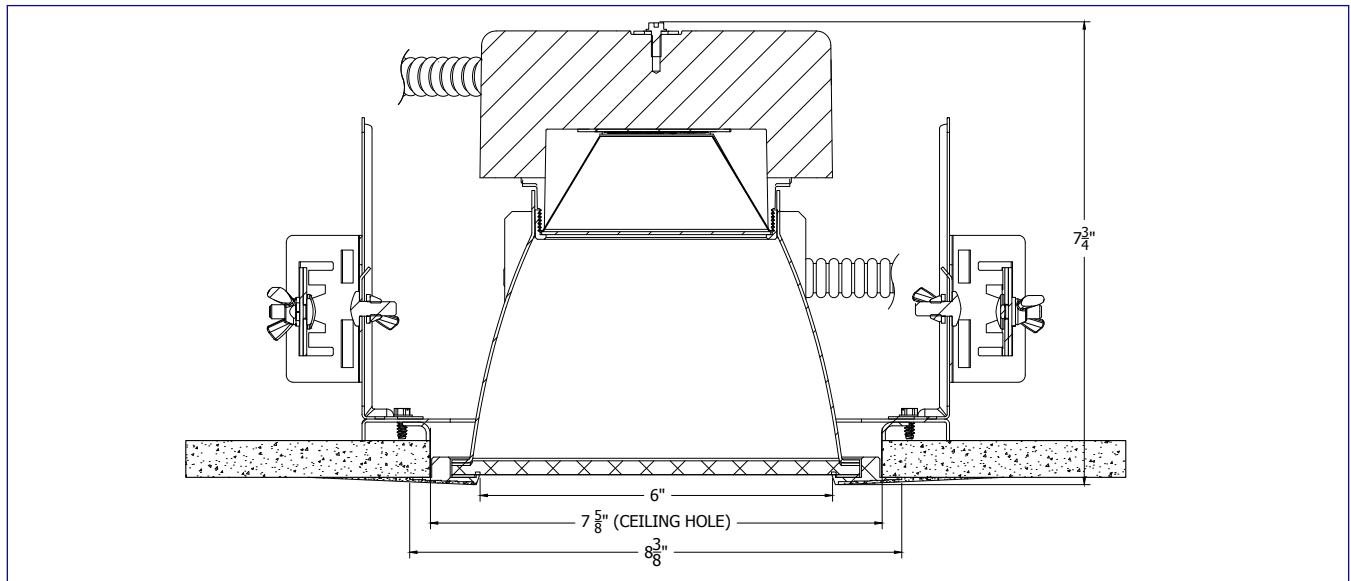

Details

Finished Ceiling Thickness

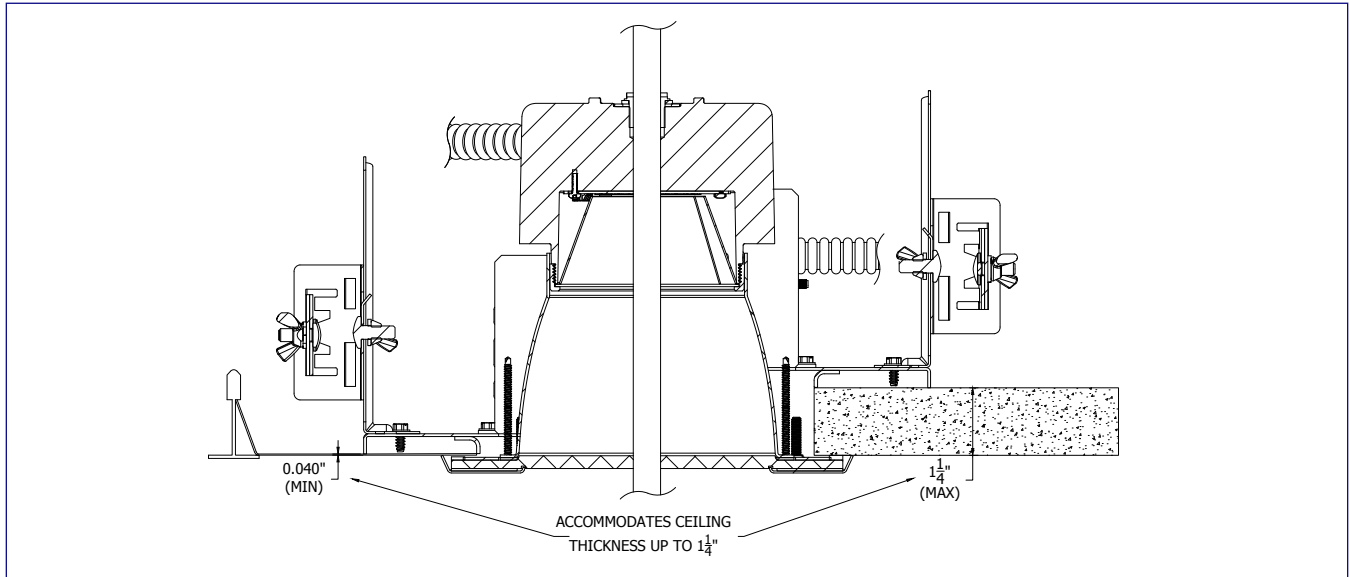

Finished CTA Ceiling Thickness

